



PROCONEL

**CONEL ELEKTRİK
EKIPMANLARI SAN. VE DIS
TIC. LIMITED SİRKETİ**

**KOSUYOLU MAH. DR. EYÜP AKSOY CAD. GÜL
APT. NO: 57
IÇ KAPI NO: B102 KADIKÖY/ İSTANBUL
www.proconel.com.tr
info@proconel.com.tr**

KATALOG

No.	Malzeme Kodu.	Kablo Kesit	A.W.G	Ölçülendirme(mm)					
				L1	L2	s1	s2	d1	d2
İZOLELİ YÜKSÜK									
 CUSTOMIZED COLOR SERVICES WAS AVAILABLE									
1	PC0306	0.34mm ²	#24	11	6	0.15	0.3	0.8	1.9
2	PC0308			13	8				
3	PC0506	0.5mm ²	#22	12	6	0.15	0.3	1.0	2.6
4	PC0508			14	8				
5	PC0510			16	10				
6	PC0512			18	12				
7	PC7506	0.75mm ²	#20	12	6	0.15	0.3	1.2	2.8
8	PC7508			14	8				
9	PC7510			16	10				
10	PC7512			18	12				
11	PC1006	1.0mm ²	#18	12	6	0.15	0.3	1.4	3.0
12	PC1008			14	8				
13	PC1010			16	10				
14	PC1012			18	12				
15	PC1508	1.5mm ²	#16	14.5	8	0.15	0.3	1.7	3.5
16	PC1510			16.5	10				
17	PC1512			18.5	12				
18	PC1518			24.5	18				
19	PC2508	2.5mm ²	#14	15.5	8	0.15	0.3	2.3	4.0
20	PC2510			17.5	10				
21	PC2512			19.5	12				
22	PC2518			25.5	18				

23	PC4009	4.0mm ²	#12	16.5	9	0.20	0.4	2.8	4.5
24	PC4010			17.5	10				
25	PC4012			19.5	12				
26	PC4018			25.5	18				
27	PC6010	6.0mm ²	#10	20	10	0.20	0.4	3.5	6.0
28	PC6012			22	12				
29	PC6018			28	18				
30	PC10-12	10.0mm ²	#8	22	12	0.20	0.5	4.5	7.6
31	PC10-18			28	18				
32	PC16-12	16.0mm ²	#6	22	12	0.20	0.5	5.8	8.7
33	PC16-18			28	18				
34	PC25-16	25.0mm ²	#4	28	16	0.20	0.5	7.5	11.0
35	PC25-18			30	18				
36	PC25-22			34	22				
37	PC35-16	35.0mm ²	#2	30	16	0.20	0.5	8.3	12.5
38	PC35-18			32	18				
39	PC35-25			39	25				
40	PC50-20	50.0mm ²	#1	36	20	0.30	0.5	10.3	15.0
41	PC50-25			41	25				
42	PC70-20	70.0mm ²	2/0	37	20	0.40	0.5	13.5	16.0
43	PC70-27			42	27				
44	PC95-25	95.0mm ²	3/0	44	25	0.40	0.8	14.5	18.0
45	PC120-27	120mm ²	4/0	47.6	27	0.45	0.8	16.5	20.3
46	PC150-32	150mm ²	250/300	53	32	0.50	1.0	19.6	23.4

ÇİFT GİRİŞLİ İZOLELİ YÜKSÜK

CUSTOMIZED COLOR SERVICES WAS AVAILABLE

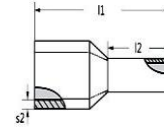
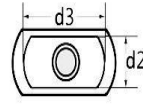

No.	Malzeme Kodu.	Kablo Kesit (mm ²)	A.W.G	Ölçülendirme (mm)						
				L1	L2	s1	s2	d1	d2	d3
1	PC0508	2x0.5mm ²	2x#22	15	8	0.15	0.3	1.5	2.8	4.9
2	PC0510			17	10					
3	PC0512			19	12					
4	PC7508	2x0.75mm ²	2x#20	15	8	0.15	0.3	1.8	2.9	5.2
5	PC7510			17	10					
6	PC7512			19	12					
7	PC1008	2x1.0mm ²	2x#18	16	8	0.15	0.3	2.0	3.5	5.7
8	PC1010			18	10					
9	PC1012			20	12					
10	PC1508	2x1.5mm ²	2x#16	15.5	8	0.15	0.4	2.3	3.9	6.5
11	PC1510			17.5	10					
12	PC1512			19.5	12					
13	PC1518			25.5	18					
14	PC2510	2x2.5mm ²	2x#14	18	10	0.20	0.4	2.9	4.6	8.0
15	PC2512			20	12					
16	PC2518			26	18					
17	PC4012	2x4mm ²	2x#12	23	12	0.20	0.5	3.8	4.9	8.8
18	PC4018			29	18					
19	PC6014	2x6mm ²	2x#10	26	14	0.20	0.5	4.9	6.3	9.3
20	PC6018			30	18					
21	PC10-14	2x10mm ²	2x#8	26.5	14	0.20	0.5	6.5	7.9	12.8
22	PC16-14	2x16mm ²	2x#6	32	14	0.20	0.6	8.3	11.6	19.3

İZOLESİZ YÜKSÜKLER

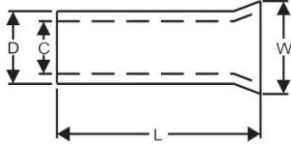





No.	Malzeme Kodu.	Kablo Kesit (mm)	A.W.G	Ölçülendirme(mm)			
				L	W	D	C
1	PC0206	0.25mm ²	#26	6	1.5	1.1	0.8
2	PC0208			8			
3	PC0306	0.34mm ²	#24	6	1.7	1.3	1.0
4	PC0308			8			
5	PC0506	0.5mm ²	#22	6	1.9	1.5	1.2
6	PC0508			8			
7	PC0510			10			
8	PC0512			12			
9	PC7506	0.75mm ²	#20	6	2.2	1.7	1.4
10	PC7508			8			
11	PC7510			10			
12	PC7512			12			
13	PC1006	1.0mm ²	#18	6	2.5	2.0	1.7
14	PC1008			8			
15	PC1010			10			
16	PC1012			12			
17	PC1018			18			
18	PC1508	1.5mm ²	#16	8	3.3	2.6	2.3
19	PC1510			10			
20	PC1512			12			
21	PC1518			18			
22	PC2506	2.5mm ²	#14	6	3.9	3.2	2.8
23	PC2508			8			
24	PC2510			10			
25	PC2512			12			
26	PC2518			18			
27	PC4009	4mm ²	#12	9	4.7	3.9	3.5
28	PC4012			12			
29	PC4018			18			
30	PC6010	6mm ²	#10	10	4.7	3.9	3.5
31	PC6012			12			
32	PC6018			18			

33	PC10-12	10mm²	#8	12	5.8	4.9	4.5
34	PC10-16			16			
35	PC10-18			18			
36	PC10-20			20			
37	PC10-25			25			
38	PC16-12	16mm²	#6	12	7.2	6.2	5.8
39	PC16-16			16			
40	PC16-18			18			
41	PC16-20			20			
42	PC16-22			22			
43	PC16-25			25			
44	PC25-12	25mm²	#4	12	9.1	7.9	7.5
45	PC25-16			16			
46	PC25-18			18			
47	PC25-22			22			
48	PC25-25			25			
49	PC36-16	35mm²	#2	16	10.2	8.7	8.3
50	PC35-20			20			
51	PC35-25			25			
52	PC50-12	50mm²	#1	12	12.7	10.9	10.3
53	PC50-18			28			
54	PC50-22			22			
55	PC50-25			25			
56	PC70-22	70mm²	2/0	22	15.8	14.3	13.5
57	PC70-25			25			
58	PC70-32			32			
59	PC95-25	95mm²	3/0	25	17.3	15.6	14.8
60	PC95-30			30			
61	PC95-34			34			
62	PC120-30	120mm²	4/0	30	20.2	17.7	16.7
63	PC120-34			34			
64	PC120-38			38			
65	PC150-32	150mm²	250/300	32	23.0	20.6	19.6
66	PC150-40			40			
67	PC185-32	185mm²	300/350	32	23.9	21.4	20.2
68	PC185-40			40			

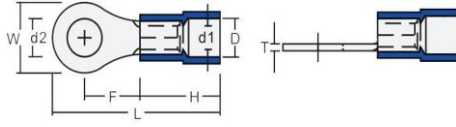
YUVARLAK TIP İZOLELİ KABLO UÇLARI

CUSTOMIZED COLOR SERVICES WAS AVAILABLE



No.	Malzeme Kodu.	Kablo Kesit (mm ²)	(mm)	A	AWG	Ölçülendirme(mm)				C	
						L	F	W	d2		
1	PC-RV1.25-3.2	0.5-1.5mm ²	0.7mm	19A	#4	17.5	5.00	5.5	3.2	 H=10.0 D=4 d1=1.7 T=0.75	
2	PC-RV1.25-3.7S				#6						3.7
3	PC-RV1.25-3.7M				#6						3.7
4	PC-RV1.25-3.7L				#6						3.7
5	PC-RV1.25-4S				#8						4.3
6	PC-RV1.25-4L				#8						4.3
7	PC-RV1.25-5				#10						5.3
8	PC-RV1.25-5L				#10						5.3
9	PC-RV1.25-6				1/4"						6.4
10	PC-RV1.25-8				5/16"						8.4
11	PC-RV1.25-8L				5/16"						8.5
12	PC-RV1.25-10				3/8"						10.5
13	PC-RV1.25-12				1/2"						13.0
14	PC-RV2-3.2	1.5-2.5mm ²	0.8mm	27A	#4	17.8	4.8	6.6	3.2	 H=10.0 D=4.5 d1=2.3 T=0.8	
15	PC-RV2-3.7				#6						3.7
16	PC-RV2-3.7M				#6						3.7
17	PC-RV2-3.7L				#6						3.7
18	PC-RV2-4S				#8						4.3
19	PC-RV2-4L				#8						4.3
20	PC-RV2-5S				#10						5.3
21	PC-RV2-5L				#10						5.3
22	PC-RV2-6				1/4"						6.4
23	PC-RV2-8				5/16"						8.4
24	PC-RV2-8L				5/16"						8.5
25	PC-RV2-10				3/8"						10.5
26	PC-RV2-12				1/2"						13.0
27	PC-RV3.5-4	2.5-4mm ²	1mm	37A	#8	25.0	8.0	8.0	4.3	 H=13.0 D=6.3 d1=3 T=1.0	
28	PC-RV3.5-5.5S				#10						5.3
29	PC-RV3.5-5.5L				#10						5.3
30	PC-RV3.5-6				1/4"						6.4
31	PC-RV3.5-8				5/16"						8.5
32	PC-RV3.5-10				3/8"						10.5
33	PC-RV3.5-12				1/2"						13.0
34	PC-RV5.5-3.2	4-6mm ²	1mm	48A	#4	22.5	5.9	7.2	3.2	 H=13.0 D=6.4 d1=3.4 T=1.0	
35	PC-RV5.5-3.7				#6						3.7
36	PC-RV5.5-4S				#8						4.3
37	PC-RV5.5-4L				#8						4.3
38	PC-RV5.5-5				#10						5.3
39	PC-RV5.5-6				1/4"						6.4
40	PC-RV5.5-8				5/16"						8.4
41	PC-RV5.5-10				3/8"						10.5
42	PC-RV5.5-12				1/2"						13.0

İZOLESİZ YUVARLAK KABLO UÇLARI

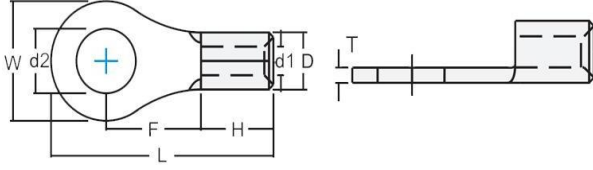

No.	Malzeme Kodu.	Kablo Kesit (mm)	Ölçülendirme(mm)				Thickness (mm)	I _{max} (A)
			L	F	W	d2		
1	PC-RNB1. 25-3. 2	0.5~1.5mm ²	12.5	5.00	5.5	3.2	0.7mm	19A
2	PC-RNB1. 25-3. 7					3.7		
3	PC-RNB1. 25-3. 7M					3.7		
4	PC-RNB1. 25-3. 7L					3.7		
5	PC-RNB1. 25-4					4.3		
6	PC-RNB1. 25-4L					4.3		
7	PC-RNB1. 25-5					5.3		
8	PC-RNB1. 25-5L					5.3		
9	PC-RNB1. 25-6					6.4		
10	PC-RNB1. 25-8					8.4		
11	PC-RNB1. 25-8L					8.5		
12	PC-RNB1. 25-10					10.5		
13	PC-RNB1. 25-12					13.0		
17	PC-RNB2-3. 2S	1.5~2.5mm ²	13.2	5.6	5.5	3.2	0.8mm	27A
18	PC-RNB2-3. 2					3.2		
19	PC-RNB2-3. 7					3.7		
20	PC-RNB2-3. 7M					3.7		
21	PC-RNB2-3. 7L					3.7		
22	PC-RNB2-4					4.3		
23	PC-RNB2-4L					4.3		
24	PC-RNB2-5					5.3		
25	PC-RNB2-5L					5.3		
26	PC-RNB2-6					6.4		
27	PC-RNB2-8					8.4		
28	PC-RNB2-8L					8.5		
29	PC-RNB2-10					10.5		
30	PC-RNB2-12	13.0						





34	PC-RNB3. 5-4	2.5~4mm ²	18.0	8.00	8.0	4.3	1mm	37A
35	PC-RNB3. 5-5					5.3		
36	PC-RNB3. 5-5L		21.4	9.4	12.0	5.3		
37	PC-RNB3. 5-6					6.4		
38	PC-RNB3. 5-8		27.0	13.3	15.0	8.4		
39	PC-RNB3. 5-10					10.5		
42	PC-RNB5. 5-3. 7	4~6mm ²	15.7	6.1		3.7	1mm	48A
43	PC-RNB5. 5-4					4.3		
44	PC-RNB5. 5-4L		19.0	8.30	9.5	4.3		
45	PC-RNB5. 5-5		19.0	8.30	9.5	5.3		
46	PC-RNB5. 5-6		22.5	10.5	12.0	6.4		
47	PC-RNB5. 5-6M					6.4		
48	PC-RNB5. 5-8		27.0	13.3	15.0	8.4		
49	PC-RNB5. 5-10					10.5		
50	PC-RNB5. 5-12		31.6	16.0	19.2	13.0		
54	PC-RNB8-4	6~10mm ²	21.5	9.3	8.0	4.3	1.2mm	62A
55	PC-RNB8-4L		23.8	9.3	12.0	4.3		
56	PC-RNB8-5		23.8	10.5	8.8	5.3		
57	PC-RNB8-5M		23.8	9.3	12.0	5.3		
58	PC-RNB8-5L		29.8	13.8	15.0	5.3		
59	PC-RNB8-6		23.3	9.3	12.0	6.4		
60	PC-RNB8-6L					6.4		
61	PC-RNB8-8		29.2	13.6	15.0	8.4		
62	PC-RNB8-10					10.5		
63	PC-RNB8-12		33.5	15.0	20.0	13.0		
64	PC-RNB14-4	10~16mm ²	29.2	13.3	12.0	4.3	1.5mm	88A
65	PC-RNB14-5					5.3		
66	PC-RNB14-6					6.4		
67	PC-RNB14-6L		32.5	14.2	16.0	6.4		
68	PC-RNB14-8					8.4		
69	PC-RNB14-10					10.5		
70	PC-RNB14-12					41.0		
71	PC-RNB22-5	16~25mm ²	33.2	15.1	12.2	5.3	1.7mm	115A
72	PC-RNB22-5L		33.5	13.5	16.5	5.3		
73	PC-RNB22-6		33.0	15.1	12.2	6.4		
74	PC-RNB22-6L		33.5	13.5	16.5	6.4		
75	PC-RNB22-8					8.4		
76	PC-RNB22-10					10.5		
77	PC-RNB22-12		42.5	19.7	22.0	13.0		

78	PC-RNB38-5	25~35mm²	39.0	17.4	15.3	5.3	1.8mm	160A			
79	PC-RNB38-6					6.4					
80	PC-RNB38-6L					42.7			17.7	22.0	6.4
81	PC-RNB38-8					39.0			17.4	15.3	8.4
82	PC-RNB38-8L		42.7	17.7	22.0	8.4					
83	PC-RNB38-10		39.0	17.4	15.3	10.5					
84	PC-RNB38-10L		42.7	17.7	22.0	10.5					
85	PC-RNB38-12					13.0					
86	PC-RNB60-6	35~50mm²	49.7	20.7	22.0	6.5	1.8mm	215A			
87	PC-RNB60-8					8.5					
88	PC-RNB60-10					10.5					
89	PC-RNB60-12					13.0					
90	PC-RNB60-14		57.5	23.5	32.0	15.0					
91	PC-RNB60-16					17.0					
92	PC-RNB60-18					19.0					
93	PC-RNB60-20					21.0					
94	PC-RNB60-22	23.0									
95	PC-RNB70-6	50~70mm²	50.0	20.0	24.0	6.5	2.0mm	235A			
96	PC-RNB70-8					8.5					
97	PC-RNB70-10					10.5					
98	PC-RNB70-12					13.0					
99	PC-RNB70-14		61.0	26.0	32.0	15.0					
100	PC-RNB70-16					17.0					
101	PC-RNB70-18					19.0					
102	PC-RNB70-20					21.0					
103	PC-RNB70-22	23.0									
104	PC-RNB80-6	70~95mm²	54.2	20.7	27.0	6.4	2.5mm	255A			
105	PC-RNB80-8					8.4					
106	PC-RNB80-10					10.5					
107	PC-RNB80-12					13.0					
108	PC-RNB80-16		68.0	32.0	32.0	17.0					
109	PC-RNB80-18					19.0					
110	PC-RNB80-20					21.0					
111	PC-RNB100-8					95~120mm²			55.6	20.40	28.5
112	PC-RNB100-10	10.5									
113	PC-RNB100-12	13.0									
114	PC-RNB100-14	69.0	32.0	32.0	15.0						
115	PC-RNB100-16				17.0						
116	PC-RNB100-18				19.0						
117	PC-RNB100-20				21.0						

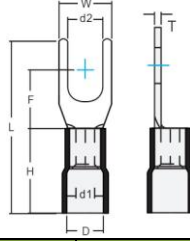
118	PC-RNB125-8	120~150mm²	62.0	22.0	32.0	8.5	3.2mm	395A
119	PC-RNB125-10					10.5		
120	PC-RNB125-12					13.0		
121	PC-RNB150-8		66.0	23.0	36.0	8.4		
122	PC-RNB150-10					10.5		
123	PC-RNB150-12					13.0		
124	PC-RNB150-14					15.0		
125	PC-RNB150-16					17.0		
126	PC-RNB150-18		81.0	36.0	36.0	19.0		
127	PC-RNB150-20					21.0		
128	PC-RNB150-22	23.0						
129	PC-RNB180-8	150~185mm²	69.0	24.50	38.5	8.4	3.5mm	440A
130	PC-RNB180-10					10.5		
131	PC-RNB180-12					13.0		
132	PC-RNB180-14					15.0		
133	PC-RNB180-16					17.0		
134	PC-RNB180-18		86.6	39.0	38.5	19.0		
135	PC-RNB180-20					21.0		
136	PC-RNB200-8	185~240mm²	72.0	24.5	44.0	8.4	4.0mm	470A
137	PC-RNB200-12					13.0		
138	PC-RNB200-14					15.0		
139	PC-RNB200-16					17.0		
140	PC-RNB200-18		91.0	37.5	44.0	19.0		
141	PC-RNB200-20					21.0		
142	PC-RNB325-12	300~400mm²	88.0	33.5	50.5	13.0	4.3mm	650A
143	PC-RNB325-16					17.0		
144	PC-RNB325-20		105.7	45.0	50.5	21.0		
145	PC-RNB325-22					23.0		

Çatal Tip İzoleli Kablo Uçları



No	Malzeme Kodu.	Kablo Kesit	Thickness	A	AWG	Ölçülendirme(mm)				C
						L	F	W	d2	
1	PC-SV1. 25-3. 2	0.5~1.5mm ²	0.7mm	1 9 A	#4	21.0	6.5	5.7	3.2	 H=10.0 d1=1.7 D=4 T=0.75
2	PC-SV1. 25-3. 7S				#6				3.7	
3	PC-SV1. 25-3. 7L				#6				3.7	
4	PC-SV1. 25-3. 7LL				#6				3.7	
5	PC-SV1. 25-4S				#8				4.3	
6	PC-SV1. 25-4M				#8				4.3	
7	PC-SV1. 25-4L				#8				4.3	
8	PC-SV1. 25-5S				#10				5.3	
9	PC-SV1. 25-5L				#10				5.3	
10	PC-SV1. 25-6S				1/4"				6.4	
11	PC-SV1. 25-6L				1/4"				6.5	
12	PC-SV1. 25-8				5/16"				8.5	
13	PC-SV2-3. 2	1.5~2.5mm ²	0.8mm	2 7 A	#4	21.2	6.5	5.7	3.2	 H=10.0 d1=2.3 D=4.5 T=0.8
14	PC-SV2-3. 7S				#6				3.7	
15	PC-SV2-3. 7L				#6				3.7	
16	PC-SV2-3. 7LL				#6				3.7	
17	PC-SV2-4S				#8				4.3	
18	PC-SV2-4M				#8				4.3	
19	PC-SV2-4L				#8				4.3	
20	PC-SV2-5S				#10				5.3	
21	PC-SV2-5L				#10				5.3	
22	PC-SV2-6S				1/4"				6.4	
23	PC-SV2-6L				1/4"				6.4	
24	PC-SV2-8				5/16"				8.5	
25	PC-SV3. 5-3. 7	2.5~4mm ²	1.0mm	3 7 A	#6	25.3	7.0	8.0	3.7	 H=13.0 d1=3 D=6.3 T=1.0
26	PC-SV3. 5-4				#8				4.3	
27	PC-SV3. 5-5				#10				5.3	
28	PC-SV3. 5-6				1/4"				6.4	
29	PC-SV3. 5-8				5/16"				8.5	
30	PC-SV3. 5-10				3/8"				10.5	
31	PC-SV5. 5-3. 7S	4~6mm ²	1.0mm	4 8 A	#6	25.5	7.0	8.3	3.7	 H=13.0 d1=3.4 D=6.4 T=1.0
32	PC-SV5. 5-3. 7				#6				3.7	
33	PC-SV5. 5-4S				#8				4.3	
34	PC-SV5. 5-4S				#8				4.3	
35	PC-SV5. 5-4L				#8				4.3	
36	PC-SV5. 5-5				#10				5.3	
37	PC-SV5. 5-6S				1/4"				6.4	
38	PC-SV5. 5-6L				1/4"				6.4	
39	PC-SV5. 5-8				5/16"				8.4	
40	PC-SV5. 5-10				3/8"				10.5	

İZOLESİZ ÇATAL TİP KABLO UÇLARI

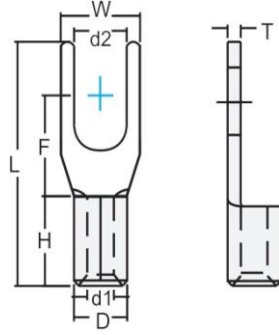



No.	Malzeme Kodu.	Kablo Kesit	Thicknes s(mm)	Ima x (A)	Ölçülendirme(mm)			
					L	F	W	d2
1	PC-SNB1. 25-3. 2	0.5-1.5m m ²	0.7mm	19A	16.0	6.50	5.7	3.2
2	PC-SNB1. 25-3. 7S						3.7	
3	PC-SNB1. 25-3. 7L						6.4	3.7
4	PC-SNB1. 25-4S						6.4	4.3
5	PC-SNB1. 25-4M						7.2	4.3
6	PC-SNB1. 25-4L						8.1	4.3
7	PC-SNB1. 25-5S							5.3
8	PC-SNB1. 25-5L						9.5	5.3
9	PC-SNB1. 25-6S							6.4
10	PC-SNB1. 25-6L				22.0	11.0	12.0	6.4
11	PC-SNB1. 25-8				21.5	11.5	13.5	8.5
12	PC-SNB2-3. 2	1.5-2.5m m ²	0.8mm	27A	16.0	6.5	5.7	3.2
13	PC-SNB2-3. 7S						3.7	
14	PC-SNB2-3. 7L						6.0	3.7
15	PC-SNB2-4S						6.4	4.3
16	PC-SNB2-4M						6.4	4.3
17	PC-SNB2-4L						8.1	4.3
18	PC-SNB2-5S							5.3
19	PC-SNB2-5L						9.3	5.3
20	PC-SNB2-6S							6.4
21	PC-SNB2-6L				22.0	11.0	12.0	6.5
22	PC-SNB2-8				21.8	11.5	13.5	8.5

23	PC-SNB3. 5-3. 7	2.5~4mm²	1.0mm	37A	18.3	7.0	8.0	3.7
24	PC-SNB3. 5-4							4.3
25	PC-SNB3. 5-5							5.3
26	PC-SNB3. 5-6							6.4
27	PC-SNB3. 5-8							8.5
28	PC-SNB3. 5-10							10.5
29	PC-SNB5. 5-3. 7S	4~6mm²	1.0mm	48A	17.4	7.5	7.2	3.7
30	PC-SNB5. 5-3. 7							3.7
31	PC-SNB5. 5-4S							4.3
32	PC-SNB5. 5-4L							4.3
33	PC-SNB5. 5-5							5.3
34	PC-SNB5. 5-6S							6.4
35	PC-SNB5. 5-6L							6.4
36	PC-SNB5. 8-8	6~10mm²	1.2mm	62A	23.5	10.5	14.0	8.4
37	PC-SNB5. 5-10							10.5
38	PC-SNB8-4							4.3
39	PC-SNB8-5							5.3
40	PC-SNB8-6							6.4
41	PC-SNB8-8							8.5
42	PC-SNB8-10							10.5
43	PC-SNB14-4							4.3
44	PC-SNB14-5	5.3						
45	PC-SNB14-6	10~16mm²	1.4mm	88A	25.5	10.7	11.0	6.4
46	PC-SNB14-8							8.4
47	PC-SNB14-10							10.5
48	PC-SNB22-5							5.3
49	PC-SNB22-6							6.5
50	PC-SNB22-8	16~25mm²	1.6mm	115A	27.8	9.5	11.0	8.5
51	PC-SNB22-10							10.5

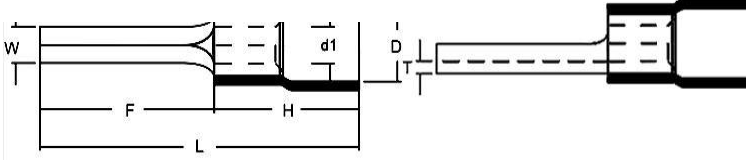
İğne Tip İzoleli Kablo Uçları



No.	Malzeme Kodu.	Kablo Kesit	Thickne ss (mm)	Ima x (A)	Ölçülendirme(mm)			C
					L	F	W	
1	PCV1.25-9	0.5-1.5 mm ²	0.7mm	19A	18.8	9.0	1.9	 H=10.0 d1=1.7 D=4 T=0.75
2	PCV1.25-10				19.8	10.0		
3	PCV1.25-12				21.8	12.0		
4	PCV1.25-13				22.8	13.0		
5	PCV1.25-14				23.8	14.0		
6	PCV1.25-18				27.8	18.0		
7	PCV2-9	1.5-2.5 mm ²	0.8mm	27A	18.8	9.0	1.9	 H=10.0 d1=2.3 D=4.5 T=0.8
8	PCV2-10				19.8	10.0		
9	PCV2-12				21.8	12.0		
10	PCV2-13				22.8	13.0		
11	PCV2-18				27.8	18.0		
12	PCV5.5-13	4-6 mm ²	1.0mm	48A	27.0	17.0	2.8	 H=13.0 d1=3.4 D=6.4 T=1.0
13	PCV5.5-18				30.5	18.0		
14	PCV5.5-25				38.0	25.0		

İğne Tip İzolesiz Kablo Uçları

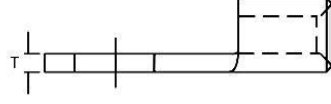
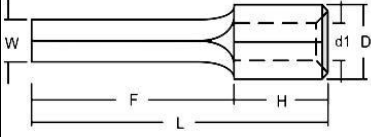

No.	Malzeme Kodu.	Kablo Kesit	Thickn ess (mm)	Ima x (A)	Ölçülendirme(mm)			C	
					L	F	W		
1	PCN1.25-9	0.5-1.5 mm ²	0.7mm	19A	13.8	9.0	1.9	 H=4.8 d1=1.7 D=3.4 T=0.8	
2	PCN1.25-10				14.8	10.0			
3	PCN1.25-12				16.8	12.0			
4	PCN1.25-13				17.8	13.0			
5	PCN1.25-17				21.8	17.0			
6	PCN2-9	1.5-2.5 mm ²	0.8mm	27A	13.8	9.0	1.9		 H=4.8 d1=2.3 D=4.0 T=0.8
7	PCN2-10				14.8	10.0			
8	PCN2-12				16.8	12.0			
9	PCN2-13				17.8	13.0			
10	PCN2-17				21.8	17.0			
11	PCN3.5-13	4-6 mm ²	1.0mm	48A	19.0	13.0	2.8	 H=6.0 d1=2.9 D=5.0 T=1.0	
12	PCN5.5-13				20.0	14.0	2.8		
13	PCN5.5-25				31.0	25.0	2.8		

BIÇAK TIP İZOLELİ KABLO UÇLARI

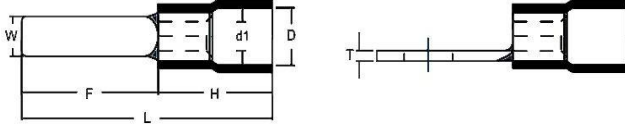

No.	Malzeme Kodu.	Kablo Kesit	Thickn ess (mm)	Ima x (A)	Ölçülendirme(mm)			C
					L	F	W	
1	PC-DBV1.25-9	0.5-1.5 mm ²	0.7mm	19A	18.8	9.0	2.8	 H=10.0 d1=1.7 D=4 T=0.75
2	PC-DBV1.25-10				19.8	10.0	2.8	
3	PC-DBV1.25-11				20.8	11.0	3.0	
4	PC-DBV1.25-14				23.8	14.0	3.0	
5	PC-DBV1.25-18				27.8	18.0	3.0	
6	PC-DBV2-9	1.5-2.5 mm ²	0.8mm	27A	18.8	9.0	2.8	
7	PC-DBV2-10				19.8	10.0	2.8	
8	PC-DBV2-13				22.8	13.0	3.0	
9	PC-DBV2-14				23.8	14.0	3.0	
10	PC-DBV2-18				27.8	18.0	3.0	
11	PC-DBV5.5-10	4-6mm ²	1.0mm	48A	23.0	10.0	2.8	 H=13.0 d1=3.4 D=6.4 T=1.0
12	PC-DBV5.5-14				27.0	14.0	4.5	
13	PC-DBV5.5-18				31.0	18.0	4.5	

BIÇAK TİP İZOLELİ KABLO UÇLARI

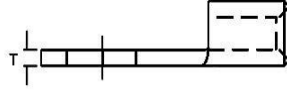
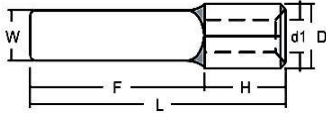

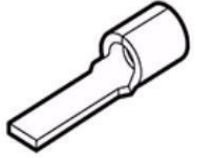
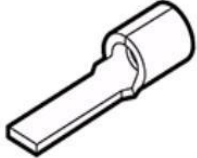
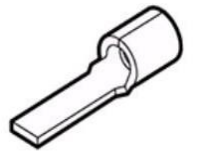

No.	Malzeme Kodu..	Kablo Kesit	Thickn ess (mm)	Ima x (A)	Ölçülendirme(mm)			C
					L	F	W	
1	PC-DBN1.25-9	0.5-1.5 mm ²	0.7mm	19A	13.8	9.0	2.8	 H=4.8 d1=1.7 D=3.4 T=0.8
2	PC-DBN1.25-10				14.8	10.0	2.3	
3	PC-DBN1.25-11				15.8	11.0	3	
4	PC-DBN1.25-11S						2.3	
5	PC-DBN1.25-13				17.0	13.0	3	
6	PC-DBN1.25-13S						2.3	
7	PC-DBN1.25-14				18.8	14.0	3	
8	PC-DBN1.25-14S						2.3	
9	PC-DBN1.25-18				22.8	18.0	2.2	
10	PC-DBN1.25-18S						2	
11	PC-DBN2-9	1.5-2.5 mm ²	0.8mm	27A	13.8	9.0	2.8	 H=4.8 d1=2.3 D=4.0 T=0.8
12	PC-DBN2-10				14.8	10.0	2.4	
13	PC-DBN2-13				17.8	13.0	2.4	
14	PC-DBN2-13L						3	
15	PC-DBN2-14				18.8	14.0	2.4	
16	PC-DBN2-14L						3	
17	PC-DBN2-18S				22.8	18.0	2	
18	PC-DBN2-18						2.2	
19	PC-DBN2-18L						2.8	
20	PC-DBN5.5-10	4-6 mm ²	1.0mm	48A	16.0	10.0	2.8	 H=6.0 d1=3.4 D=5.5 T=1.0
21	PC-DBN5.5-14S				20.0	14.0	4	
22	PC-DBN5.5-14						4.5	
23	PC-DBN5.5-18S				24.0	18.0	2	
24	PC-DBN5.5-18						4.5	

DIŐI FASTON TİP İZOLELİ KABLO UÇLARI

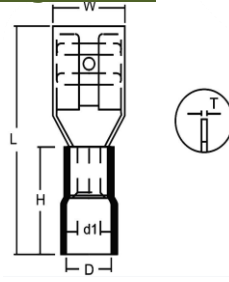
CUSTOMIZED COLOR SERVICES WAS AVAILABLE

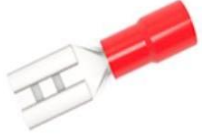



No	Malzeme Kodu.	Kablo Kesit	Size (mm)	Ölçülendirme(mm)				C	
				L	F	W	D		
1	PC-FDD1.25-110(5)	0.5-1.5 mm ²	2.8*0.5	18.6	0.3	3.2	4.0	 H=10.0 d1=1.7 D=4	
2	PC-FDD1.25-110(8)		2.8*0.8						
3	PC-FDD1.25-187(5)		4.8*0.5	19.0	0.35	5.0			
4	PC-FDD1.25-187(8)		4.8*0.8						
5	PC-FDD1.25-250		6.35*0.8	20.5	0.4	6.6			
6	PC-FDD2-110(5)	1.5-2.5 mm ²	2.8*0.5	18.6	0.3	3.2	4.5		
7	PC-FDD2-110(8)		2.8*0.8						
8	PC-FDD2-187(5)		4.8*0.5	19.0	0.35	5.0			
9	PC-FDD2-187(8)		4.8*0.8						
10	PC-FDD2-250		6.35*0.8	20.5	0.4	6.5			
11	PC-FDD5.5-250	4-6 mm ²	6.35*0.8	23.5	0.4	6.6	5.5		 H=13.0 d1=3.4 D=5.5
12	PC-FDD5.5-312		8.0*0.8	26.5	0.5	9.1			
13	PC-FDD5.5-375		9.4*1.2	28.6	0.5	10.9			

ERKEK FASTON TİP TERMINAL

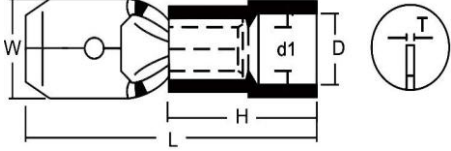

CUSTOMIZED COLOR SERVICES WAS AVAILABLE

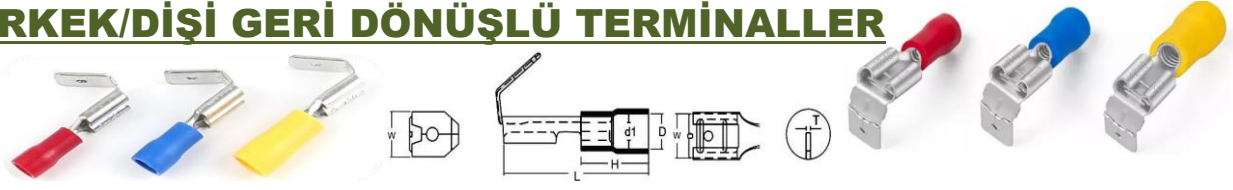

No.	Malzeme Kodu.	Kablo Kesit	Size (mm)	Ölçülendirme(mm)				C
				L	T	W	D	
1	PC-MDD1.25-110(5)	0.5-1.5 mm ²	2.8*0.5	18.6	0.3	3.2	4.0	 H=10.0 d1=1.7 D=4
2	PC-MDD1.25-110(8)		2.8*0.8		0.35	3.2		
3	PC-MDD1.25-187(5)		4.8*0.5	19.0	0.4	5.0		
4	PC-MDD1.25-187(8)		4.8*0.8		0.3	5.0		
5	PC-MDD1.25-250		6.35*0.8	20.5		6.6		
6	PC-MDD2-187(5)	1.5-2.5 mm ²	4.8*0.5	19.0	0.35	5.0	4.5	 H=10.0 d1=2.3 D=4.7
7	PC-MDD2-187(8)		4.8*0.8	19.0	0.4	5.0		
8	PC-MDD2-250		6.35*0.8	20.5	0.4	6.5		
9	PC-MDD5.5-250	4-6 mm ²	6.35*0.8	23.5	0.4	6.5	5.5	 H=13.0 d1=3.4 D=5.5
10	PC-MDD 5.5-312		6.35*0.8	26.5	0.5	9.1		
11	PC-MDD 5.5-375		6.35*0.8	28.6	0.5	10.9		

ERKEK/DİŞİ GERİ DÖNÜŞLÜ TERMİNALLER





No.	Malzeme Kodu..	Kablo Kesit (mm)	Size(mm)	Ölçülendirme(mm)				C
				L	T	W	D	
1	PCDD 1.25-250	0.5-1.5 mm ²	6.35*0.8	6.35	22.0	6.6	4.0	 H=10.0 d1=1.7 D=4 T=0.4
2	PCDD 2-250	1.5-2.5 mm ²	6.35*0.8	6.35	22.0	6.6	4.5	 H=10.0 d1=2.3 D=4.5 T=0.4
3	PCDD 5.5-250	4-6 mm ²	6.35*0.8	6.35	24.0	6.6	5.5	 H=13.0 d1=3.4 D=5.5 T=0.4

TAM İZOLELİ DİŞİ FASTON KABLO UCU

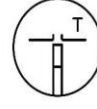
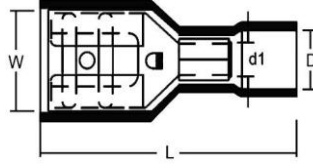

CUSTOMIZED COLOR SERVICES WAS AVAILABLE

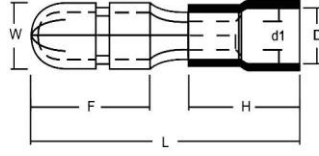

No.	Malzeme Kodu..	Kablo Kesit (mm)	Tab Size (mm)	Ölçülendirme(mm)				C	
				L	T	W	D		
1	PCFD 1.25-110(5)	0.5-1.5 mm ²	2.8*0.5	19.0	0.3	3.2	3.7	 H=11.0 d1=1.7 D=3.7	
2	PCFD 1.25-110(8)		2.8*0.8						
3	PCFD 1.25-187(5)		4.75*0.5	20.5	0.35	5.0			
4	PCFD 1.25-187(8)		4.75*0.8						
5	PCFD 1.25-250		6.35*0.8	21.8	0.4	6.6			
6	PCFD 2-110(5)	1.5-2.5 mm ²	2.8*0.5	19.0	0.3	3.2	 H=11.0 d1=2.3 D=4.2		
7	PCFD 2-110(8)		2.8*0.8						
8	PCFD 2-187(5)		4.75*0.5	20.2	0.35	5.0			
9	PCFD 2-187(8)		4.75*0.8						
10	PCFD 2-250		6.35*0.8	22.2	0.4	6.6			
11	PCFD 5.5-250	4-6 mm ²	6.35*0.8	24.2	0.4	6.6			5.6

Kurşun Erkek Terminaller



No.	Malzeme Kodu.	Kablo Kesit (mm)	Ölçülendirme(mm)					C
			L	T	W	D	H	
1	MPC1.25-156	0.5-1.5 mm ²	21.0	0.4	4.0	4.0	10	
2	MPC2-156	1.5-2.5 mm ²	21.0	0.4	4.0	4.5	10	
3	MPC2-195		21.0	0.4	5.0	4.5	10	
4	MPC5.5-195	4-6 mm ²	23.5	0.4	5.0	5.5	13	

Kurşun Dişi Terminaller

CUSTOMIZED COLOR SERVICES WAS AVAILABLE

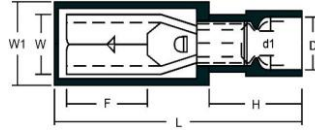

No.	Malzeme Kodu.	Kablo Kesit (mm)	Ölçülendirme(mm)					C
			L	T	W	D	H	
1	PCD1.25-156	0.5-1.5 mm ²	23.0	0.4	3.9	4.0	1.7	
2	PCD2-156	1.5-2.5 mm ²	23.5	0.4	3.9	4.5	2.3	
3	PCD2-195		24.5	0.4	4.9	4.5	2.3	
4	PCD5.5-156	4-6 mm ²	24.0	0.5	4.9	5.5	3.4	
5	PCD5.5-195		24.0	0.5	4.9	5.5	3.4	

İZOLELİ EK MUFLAR



CUSTOMIZED COLOR SERVICES WAS AVAILABLE

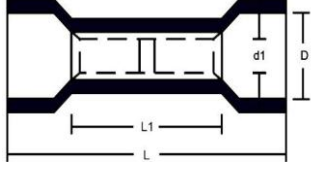

No.	Malzeme Kodu.	Kablo Kesit	MAX.Current (mm)	Ölçülendirme(mm)				C
				L	L1	D	d1	
1	PC-BV 1.25	0.5-1.5mm ²	19A	24.6	15.0	4.0	1.70	
2	PC-BV2	1.5-2.5mm ²	27A	24.6	15.0	4.5	2.50	
3	PC-BV 5.5	4-6mm ²	48A	26.5	15.0	6.3	3.40	
4	PC-BV8	6-10mm ²	62A	35.0	21.0	8.5	5.0	
5	PC-BV 14	10-16mm ²	88A	45.0	26.0	10.5	6.6	
6	PC-BV 22	16-25mm ²	115A	52.0	29.0	12.5	8.0	
7	PC-BV 38	25-35mm ²	160A	55.0	32.0	15.5	10.0	

NAYLON İZOLELİ EK MUFLAR



CUSTOMIZED COLOR SERVICES WAS AVAILABLE

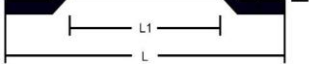

No.	Malzeme Kodu.	Kablo Kesit	MAX.Current(mm)	Ölçülendirme(mm)				C
				L	L1	D	d1	
1	PC-BNYF1.25	0.5-1.5mm ²	19A	25.2	4.0	1.7	15.0	
2	PC-BNYF2	1.5-2.5mm ²	27A	25.2	4.5	2.3	15.0	
3	PC-BNYF5.5	4-6mm ²	48A	28.2	6.3	3.3	15.0	

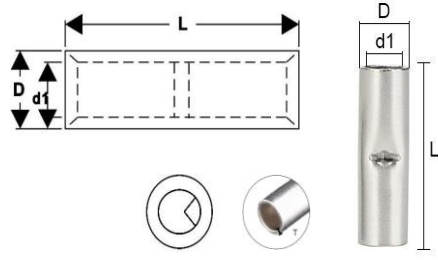

İZOLESİZ EK MUFLAR

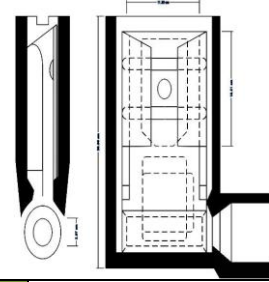

No.	Malzeme Kodu..	Kablo Kesit	A.W.G (mm)	Ölçülendirme(mm)				C
				L	L1	D	d1	
1	PC-BN 1.25	0.5-1.5 mm ²	22-16	3.3	1.7	15.0	0.8	
2	PC-BN2	1.5-2.5mm ²	16-14	3.9	2.3	15.0	0.8	
3	PC-BN 3.5	2.5-4mm ²	14-12	5.0	3.0	15.0	1.0	
4	PC-BN 5.5	4-6mm ²	12-10	5.4	3.4	15.0	1.0	
5	PC-BN8	8mm ²	8.0	7.0	4.6	21.0	1.2	
6	PC-BN 14	14mm ²	6.0	8.9	5.9	26.0	1.5	
7	PC-BN 22	22 mm ²	4.0	11.3	7.8	29.0	1.8	
8	PC-BN 38	38 mm ²	2.0	13.2	9.5	32.0	1.9	
9	PC-BN 60	60 mm ²	1/0	15.3	11.4	36.0	2.0	
10	PC-BN 70	70 mm ²	2/0	17.5	13.3	37.0	2.1	
11	PC-BN 80	80mm ²	3/0	19.5	14.5	38.0	2.5	
12	PC-BN 100	100 mm ²	4/0	22.1	16.4	38.0	2.9	
13	PC-BN 150	150 mm ²	250/300	26.4	19.5	54.0	3.5	
14	PC-BN 180	180 mm ²	300/350	28.5	21.0	57.0	3.8	
15	PC-BN 200	200 mm ²	400/500	32.4	24.0	63.0	4.2	
16	PC-BN 325	325 mm ²	500/600	37.0	28.0	72.0	4.5	

BAYRAK TİP İZOLELİ TERMİNAL



No.	Malzeme Kodu.	Kablo Kesit	Ölçülendirme(mm)					C
			L	W	H	d1	T	
1	PC-FLDNY1.25-187(5)	0.5-1.5mm ²	15.0	5.8	7.0	1.6	0.35	
2	PC-FLDNY1.25-187(8)							
3	PC-FLDNY1.25-250							
4	PC-FLDNY2-187(5)	1.5-2.5mm ²	15.2	5.8	7.0	2.1	0.35	
5	PC-FLDNY2-187(8)							
6	PC-FLDNY2-250							
7	PC-FLDNYD5.5-250	4-6mm ²	16.5	6.6	7.6	3.4	0.45	

DİŞİ-ERKEK TERMİNAL

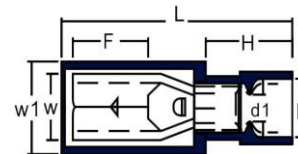
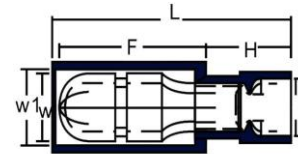

No.	Malzeme Kodu.	Kablo Kesit	Ölçülendirme(mm)					C
			L	W	H	d1	T	
1	PC-MPFNYE	0.5-0.75mm ²	24.0	6.4	11.0	1.7	1	
2	PC-FRFNYD	0.5-0.75mm ²	24.0	6.4	11.0	2.3	1	

SONLANDIRMA TERMİNAL

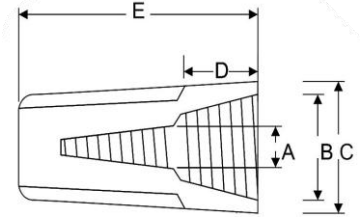

No	Malzeme Kodu.	Kablo Kesit	Ölçülendirme(mm)					C
			A	B	C	D	E	
1	PC-SP-1	300V #22 to #16 AWG Min. 2#22 Max. 2#16	5/32in.,	1/4in.,	21/64in.,	11/64in.,	37/64in.,	Grey
			4mm	6.5mm	8mm	4.5mm	15mm	
2	PC-SP-2	300V #22 to #14 AWG Min. 2#22 Max. 3#16	11/64 in.,	9/32in.,	25/64in.,	11/64in.,	45/64in.,	Blue
			4.5mm	7mm	10mm	4.5mm	18mm	
3	PC-SP-3	600V* #22 to #14AWG Min. 1 #18w / 1 #20 Max. 4 #16 w / 1 #20	11/64 in.,	11/32in.,	7/16in.,	5/16in.,	55/64in.,	Orange
			4.5mm	9mm	11mm	8mm	22mm	
4	PC-SP-5	600V* #18 to #12 AWG Min. 2 #18w Max. 4 #14 w / 1 #18	1/4 in.,	7/16in.,	35/64in.,	5/16in.,	61/64in.,	Yellow
			6.5mm	11mm	14mm	8mm	24mm	
5	PC-SP-6	600V* #18 to #10 AWG Min. 2 #14w Max. 2 #10 w / 2 #12	17/64 in.,	17/32in.,	21/32in.,	17/64in.,	1-1/16in.,	Red
			7mm	14mm	17mm	7mm	27mm	

NAYLON SONLANDIRMA KONNEKTÖR

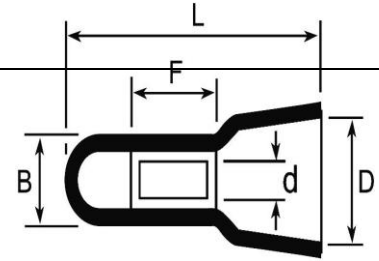

No	Malzeme Kodu.	Kablo Kesit	Max. Electric Rating (AMP)	Ölçülendirme(mm)				C
				B	L	F	D	
1	PC-CE1	22-16 AWG / 1.25mm ²	19.0	.197(5.0)	.709(18.0)	.315(8.0)	.256(6.5)	
2	PC-CE2	16-14 AWG / 2mm ²	27.0	.217(5.5)	.827(21.0)	.354(9.0)	.315(8.0)	
3	PC-CE5	12-10 AWG / 5.5mm ²	48.0	.276(7.0)	.985(25.0)	.394(10.0)	.413(10.5)	

SIKMALI KABLO PABUÇLARI

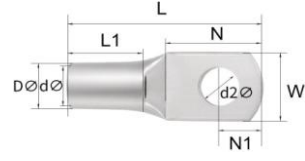

Malzeme Kodu.	Screw dia. d2(mm)	Kablo Kesit	Ölçülendirme(mm)								
			DØ	dØ	W	L1	N1	N	L	t1	t
PC 1.5-3	3.2	1.5	3.0	1.8	8.0	7.0	4.0	10.0	18.0	0.6	0.6
PC 1.5-4	4.3							10.5			
PC 1.5-5	5.3							10.5			
PC 2.5-4	4.3	2.5	4.0	2.4	8.0	7.0	5.2	11.0	20.0	0.8	0.7
PC 2.5-5	5.3				12.0						
PC 2.5-6	6.4				12.0						
PC 4-5	5.3	4	4.95	3.5	9.0	7.5	4.3	12.0	21.0	1.0	0.7
PC 4-6	6.4				10.0						
PC 6-4	4.3	6	5.5	4.1	8.0	8.8	5.3	15.0	26.0	1.1	0.7
PC 6-5	5.3				10.0					1.0	
PC 6-6	6.4				11.0					1.0	
PC 6-8	8.4				12.0					0.9	
PC 10-5	5.3	10	7.0	5.2	11.5	9.5	5.8	14.0	26.5	1.5	0.9
PC 10-6	6.4				11.8					1.2	
PC 10-8	8.4				12.8					1.2	
PC 16-6	6.4	16	8.0	6.0	12.0	11.5	7.5	18.0	32.4	1.65	1.0
PC 16-8	8.4				13.3					1.5	
PC 16-10	10.5				15.0					1.45	
PC 16-12	13.0				18.5					1.0	
PC 25-6	6.4	25	9.5	7.5	14.0	12.0	8.3	18.5	34.0	2.0	1.0
PC 25-8	8.4				14.0					1.9	
PC 25-10	10.5				15.7					1.6	
PC 25-12	13.0		9.9	18.0	13.3	9.5	10.0	22.5	41.0	1.85	1.2
PC 25-14	15.0					19.0				1.7	
PC 35-6	6.4	35	11.0	8.4	16.0	13.5	8.0	18.5	36.0	2.5	1.3
PC 35-8	8.4								37.0		
PC 35-10	10.5										
PC 35-12	13.0										

SIKMALI KABLO PABUÇLARI

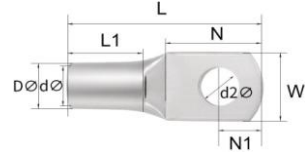

Malzeme Kodu.	Screw dia. d2(mm)	Kablo Kesit	Ölçülendirme(mm)								
			DΦ	dΦ	W	L1	N1	N	L	t1	t
PC 50-6	6.4	50	12.5	9.6	18.0	16.0	22.0	9.8	43.0	2.8	1.45
PC 50-8	8.4								43.0		
PC 50-10	10.5										
PC 50-12	13.0										
PC 70-6	6.4	70	15.0	12.0	22.0	19.5	24.0	11.0	51.0	3.0	1.5
PC 70-8	8.4										
PC 70-10	10.5										
PC 70-12	13.0										
PC 95-8	8.4	95	17.2	13.6	24.6	20.0	27.3	11.6	55.5	3.6	1.8
PC 95-10	10.5										
PC 95-12	13.0										
PC 95-14	15.0				25.0		28.0	13.2	57.0		
PC 95-16	17.0										
PC 120-10	10.5	120	20.0	16.0	29.0	23.0	29.0	13.0	63.0	3.9	2.0
PC 120-12	13.0										
PC 120-14	15.0										
PC 120-16	17.0										
PC 150-8	8.5	150	21.0	16.8	30.0	24.5	31.5	15.5	68.5	4.1	2.1
PC 150-10	11.0										
PC 150-12	13.0										
PC 150-14	15.0										
PC 150-16	17.0										
PC 185-10	11.0	185	23.7	18.7	34.5	30.5	35.5	17.0	79.0	5.0	2.5
PC 185-12	13.0										
PC 185-14	15.0										
PC 185-16	17.0										
PC 240-12	13.0	240	26.0	21.0	37.5	35.0	41.0	18.7	92.0	5.0	2.5
PC 240-14	15.0										
PC 240-16	17.0										
PC 240-18	19.0										
PC 300-12	13.0	300	30.7	23.7	44.0	41.0	45.7	21.0	102.0	6.8	3.5
PC 300-14	15.0										
PC 300-16	17.0										
PC 300-20	21.0										
PC 400-12	13.0	400	36.0	28.0	51.0	42.5	49.7	19.0	110.0	8.0	4.0
PC 400-14	15.0										
PC 400-16	17.0										
PC 400-20	21.0										
PC 500-14	15.0	500	39.0	30.0	56.0	51.0	51.0	23.5	120.0	9.0	4.5
PC 500-16	17.0										
PC 500-20	21.0										
PC 630-14	15.0	630	45.0	35.0	65.0	56.0	63.0	27.0	140.0	10.0	5.0
PC 630-16	17.0										
PC 630-20	21.0										

SIYAH KABLO BAĞI

- **Malzeme:** UL onaylı Poliamid 66, 94V-2..
- **Halojen, fosfor ve kalsiyum içermez, toprak dostu**
- **Isıya dayanıklı, erozyon kontrollü, yalıtkan ve eskimeye karşı dayanıklı**
- **Çalışma sıcaklığı: -35oC ila 85oC.**
- **Renk: doğal (siyah, standart renk),**
- **Sertifika: CE, ROHS, SGS**

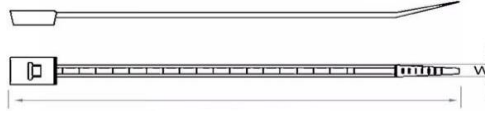

No.	En	Boy	(yükseklik)	Paket miktarı	Net Ağırlık	Paket Ölçü
1	2.5	3*100	31	500	15.500	55*34*33
2		3*120	36	450	16.200	55*34*33
3		3*150	41	400	16.400	55*34*33
4		3*200	54	300	16.200	55*34*33
5	3.6	4*150	60	350	21.000	55*34*33
6		4*200	85	250	21.250	55*34*33
7		4*250	116	200	23.200	55*34*33
8		4*300	122	175	21.350	55*34*33
9		4*350	162	125	20.250	55*34*33
10		4*370	170	125	21.250	55*40*22
11		4*400	184	100	18.400	55*34*33
12	4.6	5*150	91	225	20.475	55*34*33
13		5*200	110	175	19.250	55*34*33
14		5*250	148	125	18.500	55*34*33
15		5*300	171	125	21.375	55*34*33
16		5*350	205	100	20.500	55*34*33
17		5*380	217	100	21.700	55*34*33
18		5*400	232	90	20.880	55*34*33
19		5*450	273	75	20.475	55*34*33
20		5*500	292	70	20.440	55*34*33
21		5*550	350	50	17.500	74*30*25
22		5*650	410	50	20.500	74*30*25
23	7.6	8*200	227	90	20.430	55*34*33
24		8*250	273	75	20.475	55*34*33
25		8*300	315	60	18.900	55*34*33
26		8*350	373	55	20.515	55*34*33
27		8*400	433	50	21.650	55*34*33
28		8*450	503	40	20.120	55*34*33
29		8*500	538	40	21.520	55*34*33
30		8*550	615	40	24.600	60*45*25
31	8.8	9.0*400	595	27.5	16.363	55*40*33
32		9.0*450	650	26	16.900	55*40*33
33		9.0*500	730	29.6	21.608	55*40*33
34		9.0*550	810	20	16.200	74*30*25
35		10*600	898	20	17.960	55*34*33
36		10*650	966	20	19.320	55*34*33
37		10*700	1122	15	16.830	55*34*33
38		10*800	1205	15	18.075	55*34*33
39		10*900	1415	15	21.225	55*34*33
40		10*1000	1530	10	15.300	55*34*33
41		10*1020	1550	25	38.750	115*38*25
42		10*1100	1970	10	19.700	55*34*33
43		10*1200	2105	10	21.050	55*34*33
44		10*1220	2025	20	40.500	129*35*25

Kendinden Yapışkanlı Kablo Bağı Montajı

- Malzeme: PE, Naylon 66, 94V-2, UL sertifikalı, arkaya takılan sünger yapıştırıcı ithal edilmiştir.
- Kullanımı: Sünger yapıştırıcıyı soyun ve duvara yapıştırın, ardından teli kablo bağları ile toplayın.
- Uygulama: Kabloları ve diğer şeyleri bir araya getirmek için zamandan tasarruf sağlar ve kullanışlıdır, delik açılmayan duvarlarda kullanılır.

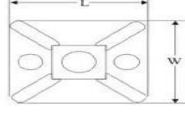
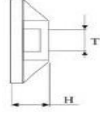

Malzeme Tanım	Malzeme Numarası.	Ölçülendirme(mm)					RESİM
		L	W	H	T	VidaDeligi	
3M-Black	20 × 20	20	20	6.1	5	2.9	
	25 × 25	25	25	7.5	6.2	3.5	
	30 × 30	30	30	8.7	6.4	4.5	
	40 × 40	40	40	6.4	10.8	-	
3M-White	20 × 20	20	20	6.1	5	2.9	
	25 × 25	25	25	7.5	6.2	3.5	
	30 × 30	30	30	8.7	6.4	4.5	
	40 × 40	40	40	6.4	10.8	-	
Glue-Black	20 × 20	20	20	6.1	5	2.9	
	25 × 25	25	25	7.5	6.2	3.5	
	30 × 30	30	30	8.7	6.4	4.5	
	40 × 40	40	40	6.4	10.8	-	
Glue-White	20 × 20	20	20	6.1	5	2.9	
	25 × 25	25	25	7.5	6.2	3.5	
	30 × 30	30	30	8.7	6.4	4.5	
	40 × 40	40	40	6.4	10.8	-	